

# » Seat Back Kit Contents

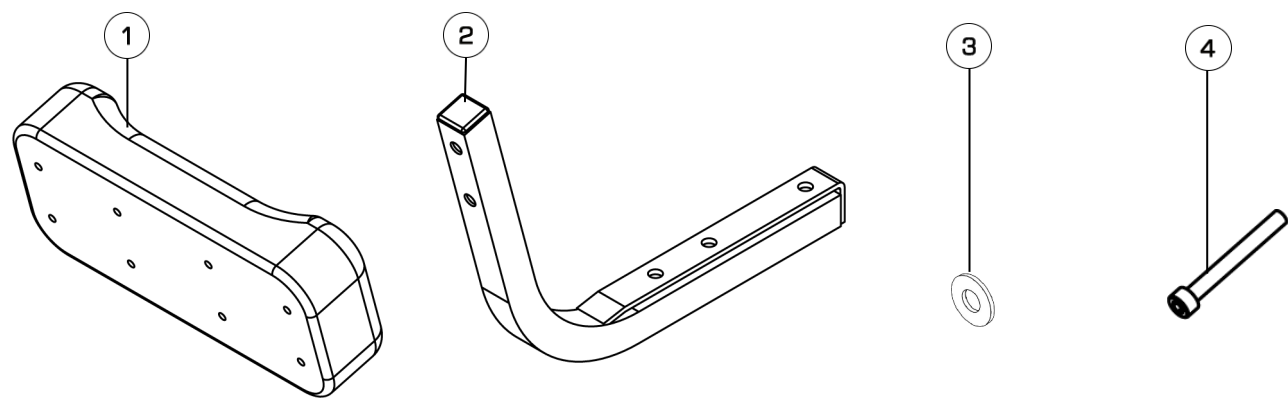

Item	Qty.	Description
1	1	Seat Back
2	2	Seat Back Frame
3	8	M6 Washer
4	8	M6x50mm Bolt
5	2	M8x160mm Bolt (Metal Seat Frame only)

Tools Required
5mm Allen Key
6mm Allen Key for Dual Rail Home Series
13mm Wrench

## » VX-2, VX-3, E316, & E520 Seat Back Assembly instructions

### STEP 1

Use 5mm Allen Key to remove 4 x M6x20mm Bolt and M6 Washers.

Either keep or discard the Bolts and Washers.

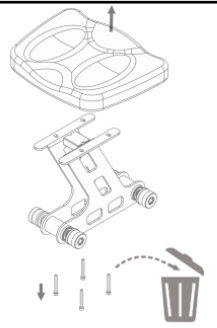

### STEP 2

Insert Seat Back Frames into the Rower Seat Bracket exactly as pictured

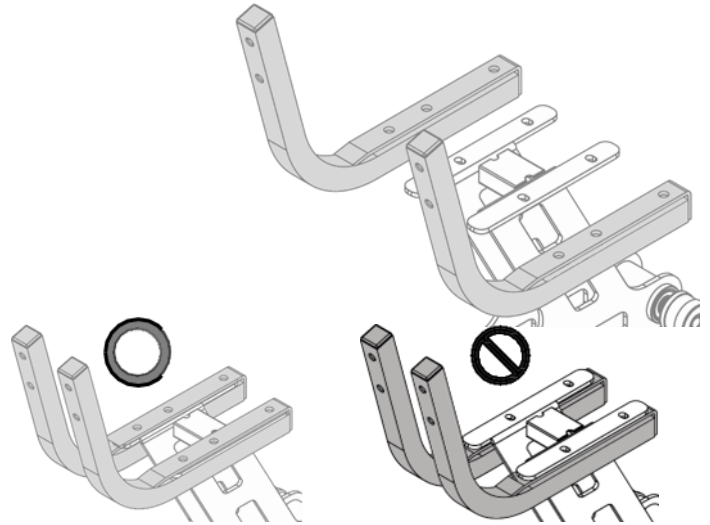

### STEP 3

Mount the Seat Base and the Seat Back as pictured. Insert and secure all 8x M6x50mm bolt and 8 x Washer,

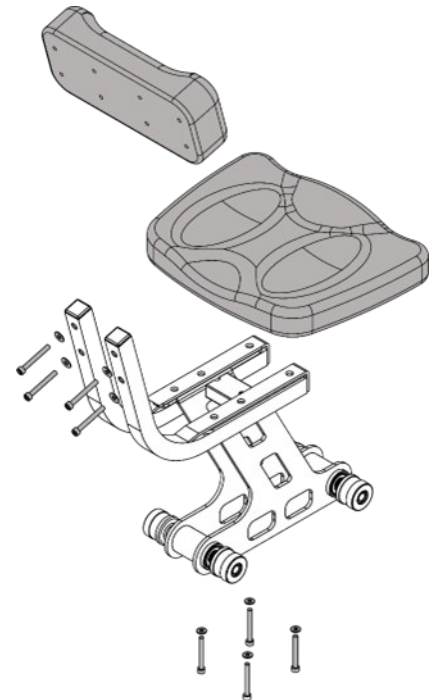

### STEP 4

Once 8 bolts are in placed , Use 5mm Allen Key to tighten them all.

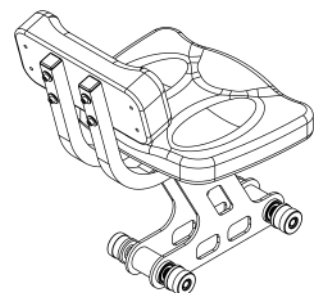

# » Seat Back Assembly instructions For Wooden Seat Frame

## STEP 1

Install the Seat Back, insert and secure with 4x M6x50mm Bolt. Do not tighten.

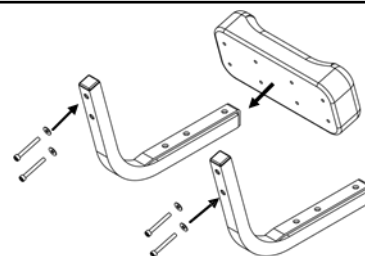

## STEP 2

Use 6mm Allen Key to remove 4 x M8x160mm Bolts.

Keep or discard the Spacers.

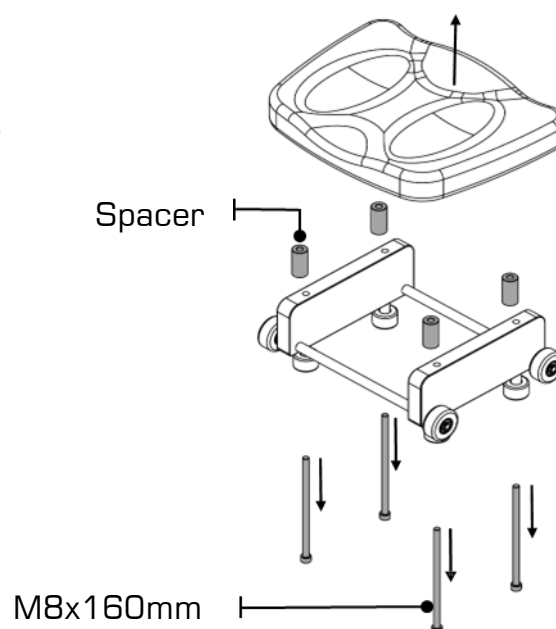

## STEP 3

Install Seat and Seat Back as pictured and secure with 4x M8x160mm Bolt. Do not tighten.

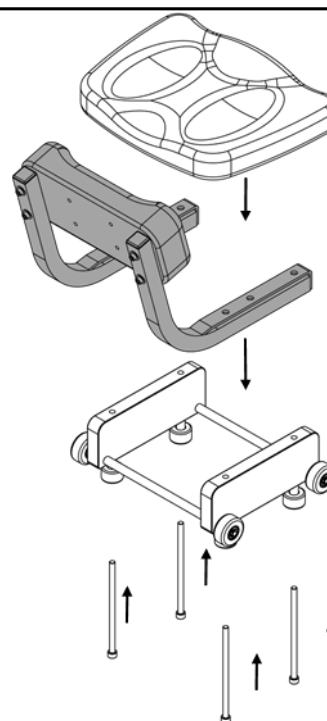

## STEP 4

Use 6mm Allen Key tighten 4 x M8x160mm Bolt.

Use 5mm Allen Key tighten 4 x M6x50mm Bolt.

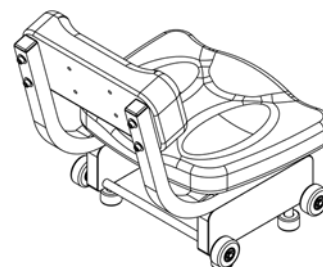

# 

## 

### 

#### 

##### 

###### 

###### 

###### 

###### 

###### 

###### 

###### 

###### 

###### 

###### 

###### 

###### 

###### 

###### 

###### 

###### 

###### 

###### 

###### 

###### 

###### 

###### 

###### 

######